



# Leakwise Oil-on-Water Detection and Monitoring Systems



GE's Leakwise\* Sensors use a High-Frequency, Electromagnetic, Energy Absorption technique. Each floating sensor houses a high-frequency electromagnetic energy transmitter and a receiving antenna which continuously monitors the liquid surface.

Since water absorbs more electromagnetic energy than hydrocarbons, changes in the absorption rate of water indicates the presence or buildup of hydrocarbons.

Leakwise Sensors not only enable reliable detection of hydrocarbon presence, but also provide valid indication of the thickness of the hydrocarbon layer and the percent of oil in oily water emulsions.

## What Leakwise Does for You

- Provides early warning with continuous detection of hydrocarbons on water starting at 0.3 mm
- Monitors buildup of hydrocarbons on water
- Provides linear measurement of hydrocarbon layer growth in the range of 1–200 mm
- Installs easily and quickly
- Operates virtually maintenance-free over extended periods of time
- Ensures reliable detection, regardless of:
  - Coating of sensor with dirt or oil
  - Changes in water salinity or temperature
  - Variations in water table
- Displays processor output with five (5) relays and five (5) indicator lights (water/air/oil/high oil/sensor disconnect); 4–20 mA, RS-485 Modbus, and optional LCD touch panel
- Sends alarm and status messages via cellular communication or PTP with optional wireless sensor

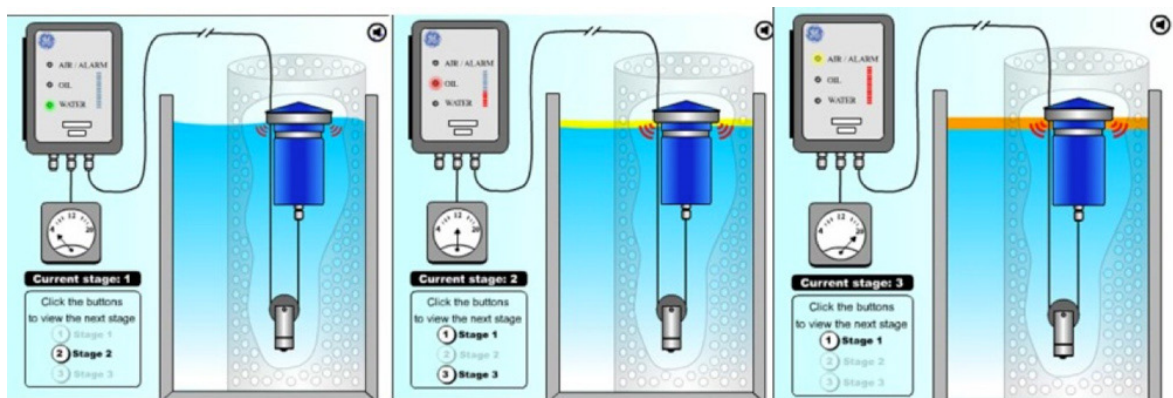

# Leakwise Versatile Sensors and Processors

**ID-225**

Measures oil thickness for oil/water separators, oil traps, wet sumps, tanks, ponds, and monitoring wells.



ID-223/2000



ID-223/2500

**ID-223/500**



**ID-223**

Operates in dry and wet sumps, open channels, and catch basins.

**ID-221**

Detects floating oil sheens in wet sumps, tanks, ponds, and monitoring wells.



**ID-227**

Works in a variety of marine and open water applications.

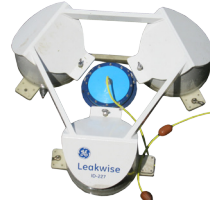

**ID-227WL/PTP**

Provides wireless monitoring near offshore oil rigs and other open water areas.



PS-220 Weather Proof



PS-220 Explosion Proof

**Versatile Signal Processors**

**PS-220**

Analog single sensor control

**SLC-220**

Digital multiple sensor control



**The Americas**  
 GE Analytical Instruments  
 6060 Spine Road  
 Boulder, CO 80301-3687 USA  
 T +1 800 255 6964  
 T +1 303 444 2009  
 F +1 303 527 1797  
 geai@ge.com

**Europe/Middle East/Africa**  
 GE Analytical Instruments  
 Unit 3, Mercury Way  
 Urmston, Manchester  
 UK M41 7LY  
 T +44 (0) 161 864 6800  
 F +44 (0) 161 864 6829  
 geai.europe@ge.com

**Asia Pacific**  
 GE Analytical Instruments  
 7/F, Building 5, No.2 Hua Tuo Rd,  
 ZhangJiang Hi-Tech Park,  
 Pudong  
 Shanghai, China 201203  
 T + (8621) 38777735  
 F + (8621) 38777469  
 geai.asia@ge.com

\*Trademark of General Electric Company; may be registered in one or more countries.

For more information, visit:

[www.geinstruments.com/leakwise](http://www.geinstruments.com/leakwise)

Find a sales partner near you through the "Contact Us" Section.

**GE Power & Water**  
**Water & Process Technologies**  
 Analytical Instruments

